

# Quick Start

## Leica DISTO™ X310

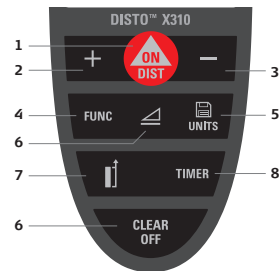

- 1 ON/DIST (on/measure)
- 2 Add
- 3 Subtract
- 4 Functions
- 5 Memory/Unit
- 6 Smart Horizontal Mode™
- 7 Measuring reference
- 8 Timer
- 9 Clear/Off

- when it has to be **right**

**Leica**  
Geosystems

### Keylock ON

**CLEAR OFF** 2 sec.

KEY  
LOCK

On

### Keylock OFF

PRESS  
MI NUS

< 2 sec.

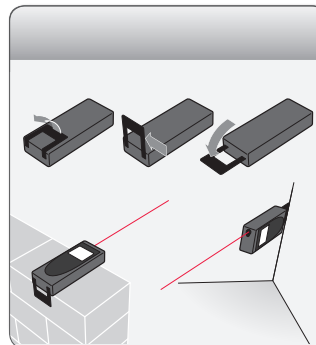

### Key Combinations

+ 2 sec.

+ 2 sec.

+ 2 sec.

**change tilt units**

2 sec.

**change units**

### Reference

1x

2 sec.

**permanent**

### Tripod

2x

3x (default)

### UNITS

1x

**history (1-20)**

1 ... 20

20 ... 1

2 sec.

**use for calculations**

+ 2 sec.

**delete history**

### 1x

1

### 2x

H3  
H2  
H1

$\beta$   
 $\alpha$

1



ON DIST

ON REP

CLEAR OFF

ON DIST

ON DIST

1x → ON

2 sec. → OFF

1x

2 sec.

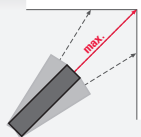
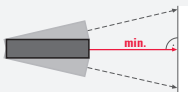

FUNC 1x

→ FUNC 2 sec.

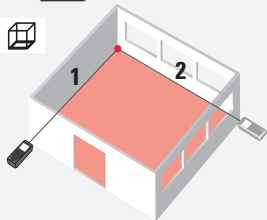

FUNC 3x

→ FUNC 2 sec.

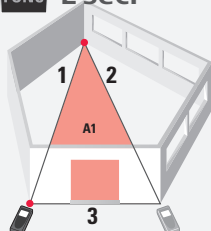

FUNC 5x

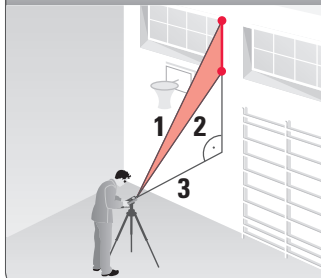

FUNC 2x

→ FUNC 2 sec.

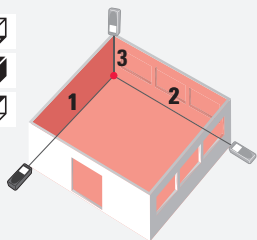

FUNC 4x

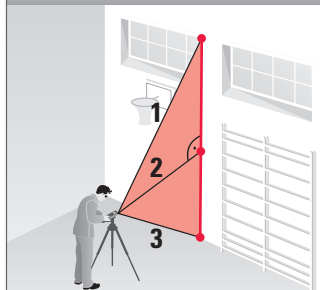

FUNC 6x

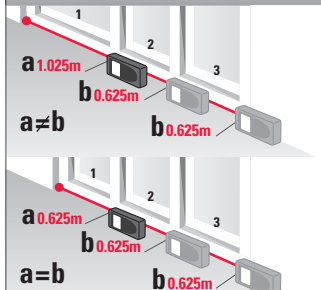

Laser class 2 in acc. to IEC 60825-1

[www.disto.com](http://www.disto.com)



SAP. No. 788 481

